

FACILITY USAGE RATES

as of January 2013

EVENT SPACE	USAGE RATE
THE OVERLOOKS OF RAILROAD PARK	
Community Foundation of Greater Birmingham Overlook at 18th Street	\$1,000
Sterne Agee Rain Curtain Overlook	\$900
Hugh Kaul Foundation Overlook at 14th Street	\$600
REGIONS BANK AMPHITHEATER	\$2,000
REGIONS BANK 17TH STREET PLAZA	\$2,100
Section A, Regions Bank 17th Street Plaza	\$1,200
Section B, Regions Bank 17th Street Plaza	\$1,500
THE GARDENS OF RAILROAD PARK	
Susan Mott Webb Memorial Gardens	\$400
Hill Crest Foundation Gardens	\$200
ON THE GREEN	
The Hillside	\$1,500
Protective Life Corporation Meadow	\$2,000
Alagasco West Green	\$1,000
VULCAN MATERIALS COMPANY FOUNDATION LAWN TERRACES	\$1,500
EBSCO INDUSTRIES, INC. WEST GATE	\$500
RENTAL PACKAGES	
A Piece of Green	\$200
Your choice of lawn space. Includes one pop-up tent, one serving table and one garbage can. Four hour reservation.	
The Caboose	\$200
1/4 section of Regions Bank 17th Street Plaza Section A, tables and chairs for 20, one serving table. Four hour reservation.	
The Railway	\$400
1/4 section of Regions Bank 17th Street Plaza Section B, tables and chairs for 40, two serving tables. Four hour reservation.	
The Conductor	\$600
1/2 section of Regions Bank 17th Street Plaza Section B, tables and chairs for 60, four serving tables. Four hour reservation.	
The Lakefronts at Railroad Park	\$50
Includes one serving table, seat walls, and one garbage can. Four hour reservation.	

DISCOUNTS

Non-Profit: Non-profit organizations receive a 20% discount off of facility usage. A copy of the organization's 501c3 must accompany the Events Request Form. The non-profit discount does not apply to any of the Railroad Park packages.

The Winter Rail: November 1 through February 29 all facility usage fees and packages are 20% off.

Summer Tracks Discount: July 1 through August 31 all facility usage fees and packages are 20% off.

RXR Discount: Rent two or more facility usage areas at the same time and receive a 10% discount off of your total facility usage fee.

Book your space now! Call 205-521-9933

Email events@railroadpark.org Online www.railroadpark.org

HOST YOUR NEXT EVENT ON
Birmingham's
FRONT LAWN



**Railroad Park is Birmingham's premier location
for your next outdoor gathering.**



Your Map to Great



Event Space at RRP!

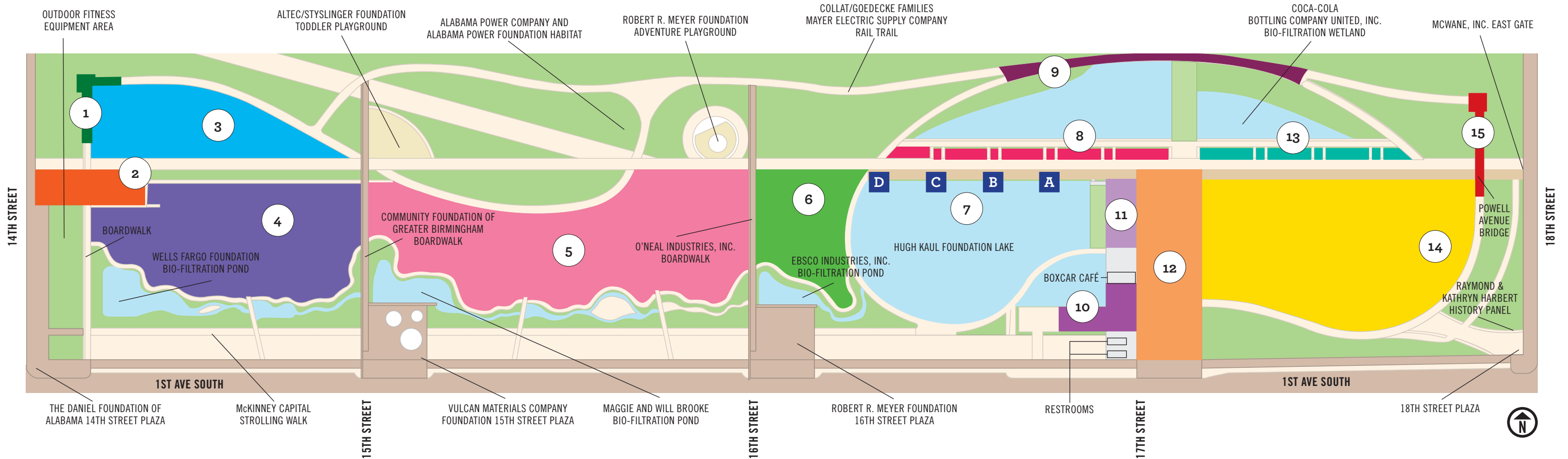

EVENT SPACES:

- 1 HUGH KAUL FOUNDATION OVERLOOK AT 14TH STREET**
Exclusive area with elevated vantage point overlooking the Park and downtown Birmingham. Perfect for small gatherings of VIPs or friends.
- 2 EBSCO INDUSTRIES, INC. WEST GATE**
A unique mix of green space and brick pavers to host your event.
- 3 VULCAN MATERIALS COMPANY FOUNDATION LAWN TERRACES**
More than 20,000 square feet of terraced green space may be rented alone or in combination with the Alagasco West Green. This area includes the Hugh Kaul Foundation Overlook at 14th Street and the EBSCO Industries, Inc. West Gate.
- 4 ALAGASCO WEST GREEN**
Expansive area bordered by walking path and ponds. Large seat wall provides optional seating for guests.
- 5 PROTECTIVE LIFE CORPORATION MEADOW**
Our largest green space, with nearly 57,000 square feet. Located in the heart of the Park, bordered by a pond and wetland stream, convenient to both play areas.
- 6 THE HILLSIDE**
Spectacular elevated view of the entire Park, bordered by a pond and small walking trail.
- 7 LAKEFRONT, SECTIONS A, B, C, D**
Four separate lakefront spots with seat walls and beautiful views of the Park. Ideal for small gatherings.
- 8 SUSAN MOTT WEBB MEMORIAL GARDENS**
Peaceful Park views with privacy. Close to amenities, seat walls for ample seating.
- 9 STERNE AGEE RAIN CURTAIN OVERLOOK**
One of a kind location overlooking the Park. Great views of the Birmingham skyline.
- 10 REGIONS BANK 17TH STREET PLAZA, SECTION A**
2,000+ square feet of covered area close to amenities, includes café seating upon request. Also includes small green space.
- 11 REGIONS BANK 17TH STREET PLAZA, SECTION B**
Nearly 3,000 square feet of covered space affords premium views of the Park. Near amenities, includes café seating upon request.
- 12 REGIONS BANK 17TH STREET PLAZA**
Expansive bricked area combined with two large covered pavilions (Sections A & B). Convenient to amenities; ideal for large events of all kinds.
- 13 HILL CREST FOUNDATION GARDENS**
Close to amenities, seat walls for ample seating. Adjacent to Regions Bank Amphitheater.
- 14 REGIONS BANK AMPHITHEATER**
Large grassy area close to amenities, accommodates up to 4,000 people. Area is often combined with the Regions Bank 17th Street Plaza for large scale events and concerts.
- 15 COMMUNITY FOUNDATION OF GREATER BIRMINGHAM OVERLOOK AT 18TH STREET**
Elevated vantage point affording breathtaking views of the Park and Birmingham's skyline. Perfect for small gatherings.

**BOOK YOUR SPACE
NOW!**

CALL 205-521-9933

EMAIL EVENTS@RAILROADPARK.ORG

FOR MORE INFORMATION, GO ONLINE
WWW.RAILROADPARK.ORG